

DryMix Processing

Manual Bag Openers RSM and RSMX

11



Description ▼

RSM Manual Bag Openers are manufactured from mild steel or stainless steel and consist of a grille with a rest fitted to their front. The grille is mounted on top of a hopper which is supported by four feet. A fabricated hood with protection door fitted to the front covers the hopper and grille. RSM Bag Openers are manufactured in high finishing-grade materials and come with or without integrated de-dusting filter unit. In the version with integrated dust filter the filter elements are cleaned pneumatically by reverse air jet.

Function ▼

The operator puts the bag on the rest and pushes it on to the grille. He then slits the bag open with a vertical cut and shakes it empty. While the bag content may be discharged through a hopper or by BINSWEEP®, a special rotary discharging device, into any type of feeder, the built-in fan operated, air jet cleaned dust collector filters the dust generated during emptying. The empty bag is dropped into the chute on the side which leads into the optional COM-type Waste Bag Compactor (see COM). Manual RSM Bag Openers are designed to minimise material residue. They satisfy a large number of applications due to their modular component design.



Application ▼

RSM Manual Bag Openers are used to transfer raw materials such as additives contained in bags to the mixer or to silos for storage. The material is normally conveyed pneumatically or mechanically into the mixer or silo.

Benefits ▼

- ✓ Residue-free internal design;
- ✓ Easy and quick access to all internal parts for cleaning;
- ✓ Space-saving overall dimensions and compact user-friendly design;
- ✓ Built-in fan-operated, air jet-cleaned, maintenance-friendly dust collector;
- ✓ With optional BINSWEEP® Rotary Discharging Device (see sheet) low overall height;
- ✓ Attractive price-performance ratio.

DryMix Processing

Manual Bag Openers RSM and RSMX



Technical Features / Performance ▼

- ▶ Material: mild steel or stainless steel
- ▶ Gas spring-supported residue-free access door on demand
- ▶ Available with de-dusting filter or equipped for centralised dust suction
- ▶ Filter element options: round or elliptical bags
- ▶ Filter surface from 3 to 22m² (32 sq ft)
- ▶ Collecting hoppers with different volume capacity
- ▶ Support feet with possibility of height adjustment

Overall Dimensions ▼

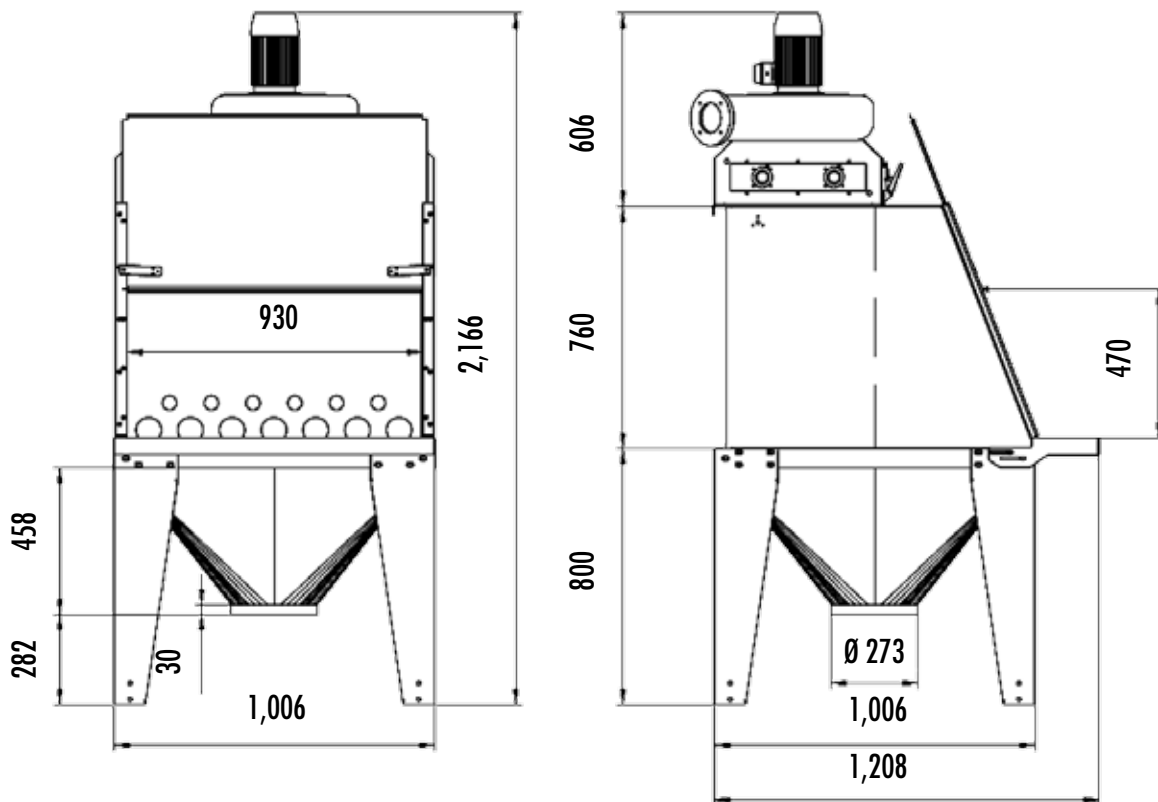

* Depending on the height of the filter elements and on the type of support feet

** Depending on the hopper model

Further outlet dimensions reported in Technical Catalogue