

Animal Feed Milling

EXTRABEND® and EXTRACURVE® Pipe Elbows

27

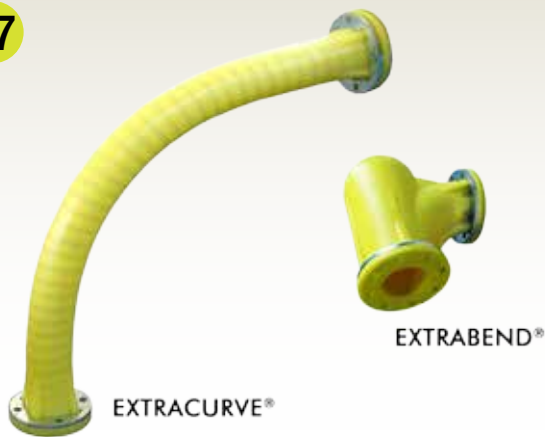

Description ▼

Short-radius EXTRABEND® and wide-radius EXTRACURVE® Pipe Elbows are inserted as a link in pneumatic conveying ducts. Both models are manufactured from a one-piece SINT® engineering polymer cast. Wear-resistant EXTRABEND® and EXTRACURVE® Pipe Elbows deflect incoming powders, pellets or granular materials towards the outlet minimising material degradation and elbow wear, avoiding at the same time any clogging or plugging.

Function ▼

The EXTRABEND® short-radius Pipe Elbow offers a substantially innovative geometry suitable to reduce wear during operation in all types of dilute phase pneumatic conveying systems.

The body cavity next to the point of diversion generates an internal material turbulence which protects the elbow from wear caused by the material travelling through the duct.

The EXTRACURVE® represents the latest evolution in the development of wide angle pipe elbows. Due to its flexibility and adaptability installation is quick while durability is highly increased.



Application ▼

EXTRABEND® and EXTRACURVE® Elbows are used as a link in silo filling pipes and in ductworks of pneumatic conveying systems. They excel through their particular resistance to wear with abrasive materials.

Benefits ▼

- ✓ Long-life elbow suitable for abrasive materials thanks to anti-wear SINT® engineering polymer material;
- ✓ Reduced installation costs thanks to elastic properties (no extra work for connection on site required);
- ✓ Reduced installation and maintenance time as elbows are easy to handle thanks to lightweight design;
- ✓ Reduced costs for project designing thanks to elastic properties (elastic elbows fit different plant layouts);
- ✓ Considerable reduction of noise and flow resistance, consequently energy saving pneumatic conveying.

Animal Feed Milling

EXTRABEND® and EXTRACURVE® Pipe Elbows



Technical Features / Performance ▼

- ▶ SINT® engineering polymer
- ▶ Range from 2" to 4"
- ▶ PN-type connecting flanges
- ▶ Up to 1.5 bar (22 psi) in lean phase
- ▶ Max temperature: 80° C (176° F)

Overall Dimensions ▼

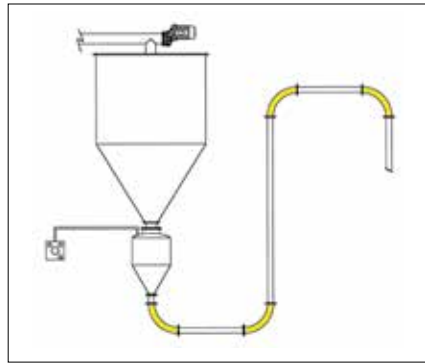
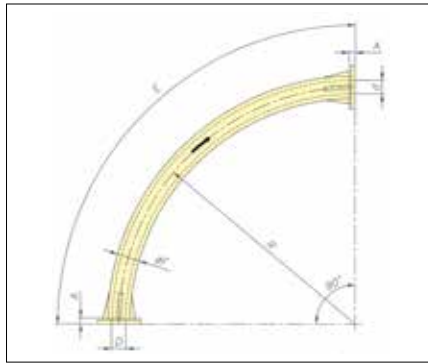

EXTRACURVE®

EW	A	Ød	ØD	E	ØF	R	kg
2"	23	52	55	1,400	85	900	7.3
3"	30	80	83	1,400	110	900	9.6
4"	30	105	108	1,400	140	900	13.4

Dimensions in mm

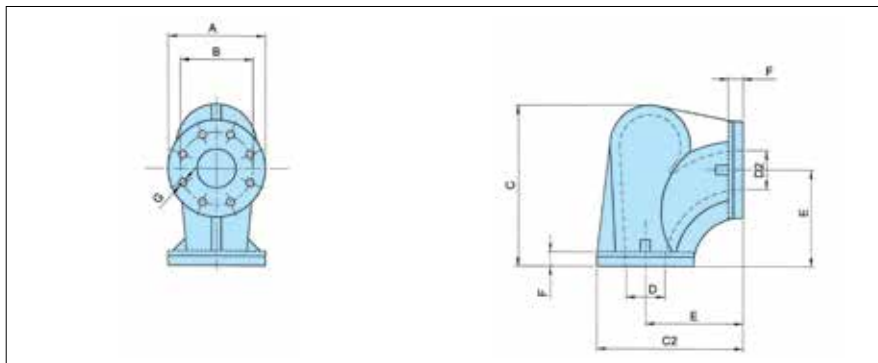

EXTRABEND®

Type	Ø Piping	A	B	C	C2	Ø D	Ø D2	E	F	Ø G	Flange Drillings	kg
EB 2	2"	165	125	232	220	55	52	140	23	18	4	2
EB 3	3"	200	160	330	300	85	80	200	30	18	4	5
EB 4	4"	220	180	435	373	108	105	263	30	18	8	7

Dimension in mm